

Linkind

User Manual

Smart Permanent Light

HP5 & HP5H

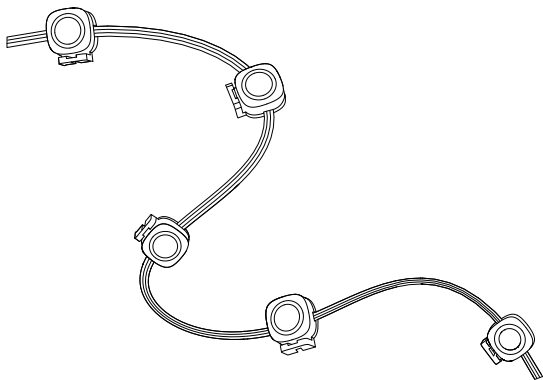

Works
with

AiDot



Scan To Get Support

CONTENT English

Package List	01
Specifications	01
Features	02
Dimensions	02
Installation Guide	03
Control Box	08
Connecting to AiDot App	08
Light Count Detection	09
Troubleshooting	10
Warning	11

Package List

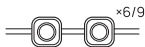

16.6ft
String Lights*6



Power
Adapter*1



Controller*1



Extra
Adhesive*3



10ft Extension
Cable*1



Clips*30

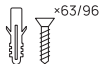

Screws
for Lights*63



Screws
for Clips*30



Positioning
Card*1

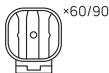

Mounting
Bracket*60



User
Manual *1

Specifications

Adapter Input	AC 100-240V, 50/60Hz
Voltage	DC 36V
Current	2A
Power	72W
LED Number	60/90
Color Temp	2700K~6500K
Light Output	3000lm / 4500lm (50lm per bulb)
Beam Angle	100°
Waterproof	Light string (IP67); Control box (IP65); Adapter (IP44)
TA	-20°C to 40°C / -4°F to 104°F
Length	100ft (30m) / 150ft (45m)
Connection	Wi-Fi+Bluetooth

Features

These elegant permanent lights add vibrant colors and inviting ambiance to your outdoor space. With over 16 million colors and a full spectrum of white light, you can create any atmosphere from cozy glow to festive lights. Easily controlled via a mobile app, they enhance your home's curb appeal and bring endless possibilities to your outdoor living.



16 Million Colors



Tunable
White



Music Sync



Schedule



Preset Scenes



Extended Wire



DIY



IP67 Waterproof

Dimensions

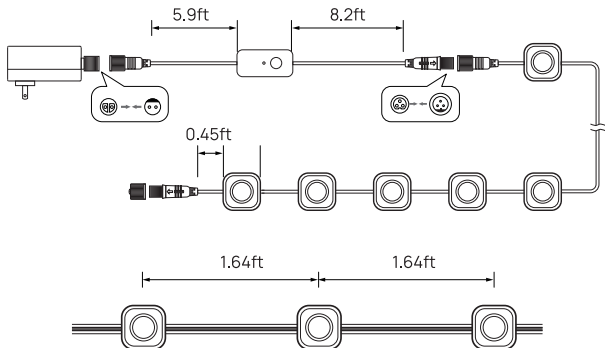

Installation Guide

⚠ Before installing the permanent lights, please connect each segment of the lights and then power on to confirm if all devices are functioning properly.

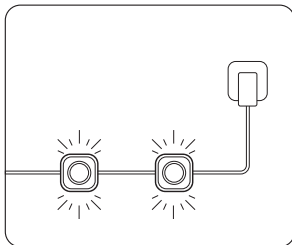
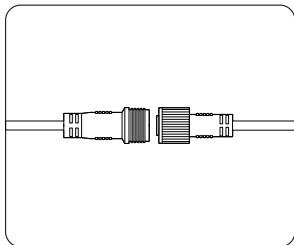

Note: Connect first, then power on. Do not connect after powering on to avoid a sudden surge of current that may damage the devices.

Method 1: Eaves Installation

1. Clean the surface of the planned installation area with a cloth or tissue, ensuring it is dry and free from debris.
2. Use the positioning card to determine the distance from the wall, with a recommended distance of 5-10cm.

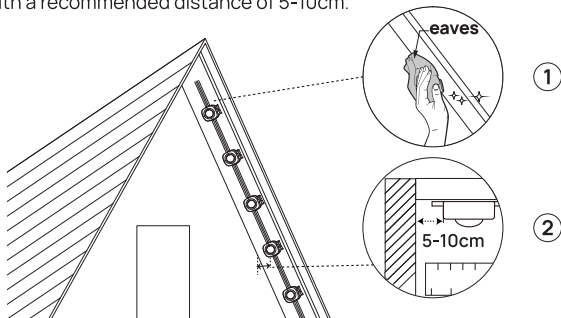

3. Mark the position on the eaves where you plan to install the light, drill a hole at the marked position and insert the expansion screw.

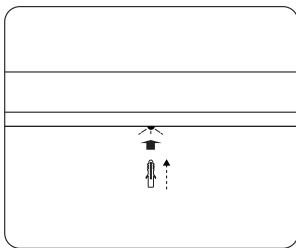
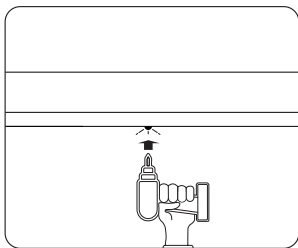

4. Remove the protective film from the adhesive on the back of the bracket. Attach it to the eaves to ensure it sticks securely.

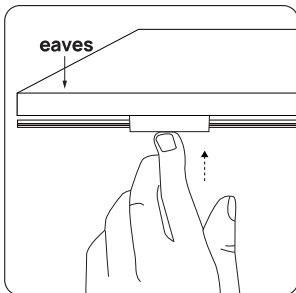
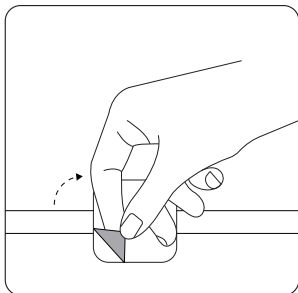

5. Align the screw with the expansion bolt hole and tighten it to ensure the bracket is firmly pressed against the surface.

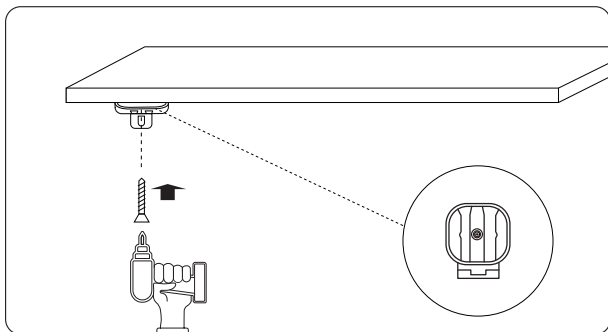

6. Slide the light horizontally into the slot on the base and secure it.

7. Pull the wire to the next installation position, then repeat the process from Step 2 until all installations are complete.

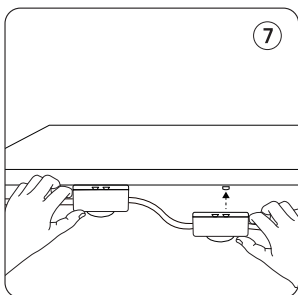
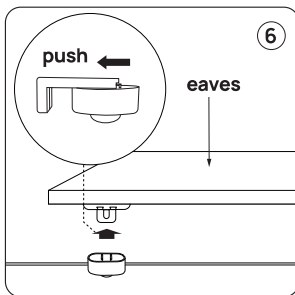

8. Secure the wire with clips. If necessary, the clips can also be further secured with screws.

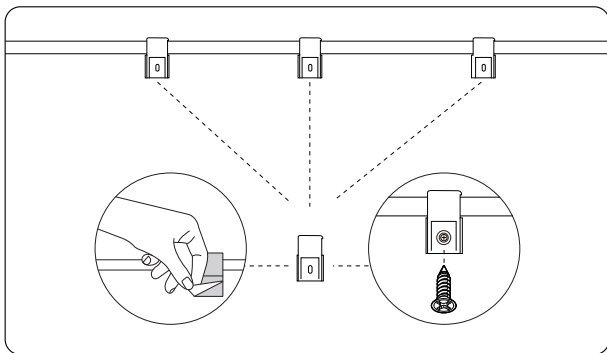

Note: Adhesive tape should not be used as the primary means of installation. It is recommended for auxiliary support only.

Method 2: Walls Installation

1. Mark the position on the eaves where you plan to install the light, drill a hole, and insert expansion bolt, then align the screw hole in the bracket and tighten the screw.

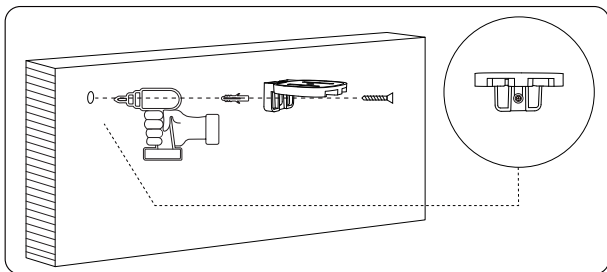

2. Slide the light horizontally into the slot on the base and secure it.

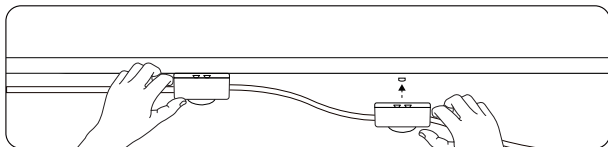
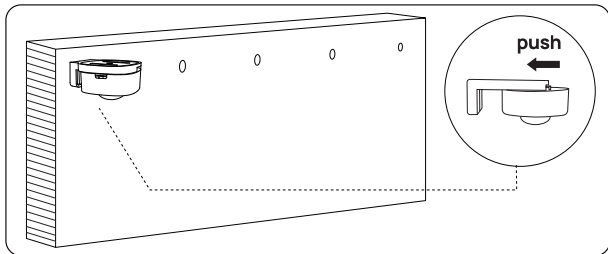

Tips:

The extension cords can be used if the strings need to be extended. Clips are recommended to fix the cable to the desired position.

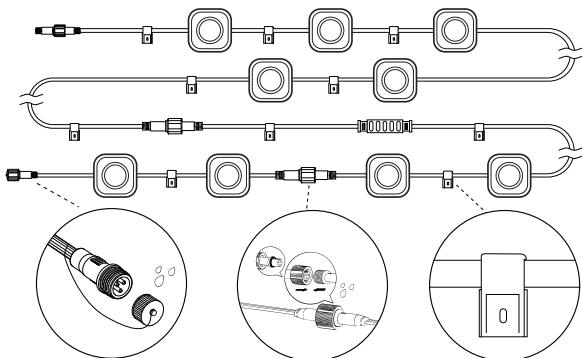

If you require additional LEDs, this light strip can be extended up to 150 feet.

Control Box

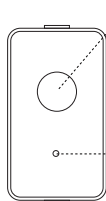

On/Off Button

- Short press: Select desired mode between 8 default preset modes or turn off the light.
- Long press: Hold for 5s to enter the default mode.

Music Sync MIC

Music sync with AiDot App.

*Explore extra features via the app.

Connecting to AiDot App

1. Search "AiDot" on the App Store, Google Play, or simply scan the QR code.



AiDot App

Google, Google Home and Google Play are trademarks of Google LLC.

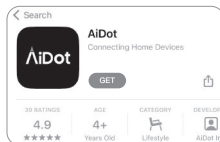

Download Interface

2. Open the AiDot App and sign in, or create a new account.
3. Make sure Bluetooth is enabled on your mobile device.

4. Press and hold the button on the light until it enters pairing mode.
5. Tap "Add Device" or the "+" button. You can also use the "Nearby" option, which will search for nearby AiDot products in pairing mode. The App may ask for Bluetooth permissions on your phone. Allow these to connect to the device.

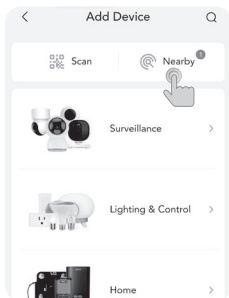
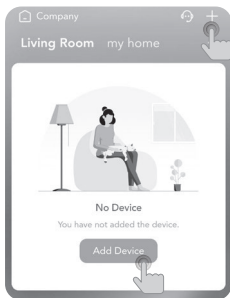

6. The AiDot App will guide you through the rest of the process. You can find more features and fun DIY in it.

Light Count Detection

To ensure your permanent lights are functioning properly, we offer three easy methods for detecting and calibrating the number of lights. Here's how to perform each one:

Automatic Detection: After setting up your lights via the app, the system will automatically detect and calibrate them.

Manual Detection: Tap "Detect" in the app to manually check and calibrate your lights at any time.

Manual Entry Calibration: If needed, select "Enter Manually," input your light count, and the system will save your settings. For any issues, contact our customer service.

Trouble Shooting

1. The lights do not work/are malfunctioning:

- a) Check if the adapter used is the one provided.
- b) Power the lights off then on. Make sure the adapter and the control box have been powered on.
- c) Long press and hold the power button on the control box to enter the default mode.

2. Cannot connect to AiDot App:

- a) Do not skip the Bluetooth connection in the app.
- b) Ensure Bluetooth on your smartphone has been turned on.
- c) Power the lights and your smartphone Bluetooth off then on, then try again.
- d) Clear any obstructions that are between the lights and your smartphone.

3. Device shows offline:

- a) Please try controlling the device to see if it responds normally.
- b) If the device does not respond, please try to power on the device again, and wait for 2 minutes to check whether the device is back online.

4. How do I detect and calibrate the number of the lights?

You can detect and calibrate the number of the lights using three methods: Automatic Detection,;Manual Detection, or Manual Entry Calibration.

5. What is the maximum number of light bulbs that can be extended?

The light bulbs can be extended up to 150ft, which is equivalent to a maximum of 90 bulbs.

6. How to get support?

Email: service@linkind.com

Support Phone: 1-877-770-5727 (Monday-Friday 8:00am-5:00pm)

7. What is the warranty period for the permanent lights?

We offer a one-year limited warranty.

WARNING

This device complies with part 15 of the FCC Rules. Operation is subject to the following two conditions: (1) this device may not cause harmful interference, and (2) this device must accept any interference received, including interference that may cause undesired operation.

Any changes or modifications not expressly approved by the party responsible for compliance could void the user's authority to operate the equipment.

NOTE: This equipment has been tested and found to comply with the limits for a Class B digital device, pursuant to Part 15 of the FCC Rules. These limits are designed to provide reasonable protection against harmful interference in a residential installation. This equipment generates, uses and can radiate radio frequency energy and, if not installed and used in accordance with the instructions, may cause harmful interference to radio communications.

However, there is no guarantee that interference will not occur in a particular installation. If this equipment does cause harmful interference to radio or television reception, which can be determined by turning the equipment off and on, the user is encouraged to try to correct the interference by one or more of the following measures:

- Reorient or relocate the receiving antenna.
- Increase the separation between the equipment and receiver.
- Connect the equipment into an outlet on a circuit different from that to which the receiver is connected.
- Consult the dealer or an experienced radio/TV technician for help.

To maintain compliance with FCC's RF Exposure guidelines, This equipment should be installed and operated with minimum 20cm distance between the radiator and your body: Use only the supplied antenna.



The Bluetooth® word mark and logos are registered trademarks owned by Bluetooth SIG, Inc. and any use of such marks by Linkind is under license.

Other trademarks and trade names are those of their respective owners.



SPRING SUNSHINE TECHNOLOGY CO., LIMITED

Address: FLAT/RM 01-04, 24/F, FU FAI COMMERCIAL CENTRE, 27 HILLIER STREET,
SHEUNG WAN, HONG KONG, CHINA, 999077

☎ Phone: 1-877-770-5727 Mon. – Fri., 8:00 AM to 5:00 PM (PT)  @linkind.lights

 Web: www.linkind.com

 @linkindofficial

 Email: service@linkind.com

 @linkindofficial