

# ENHULK

20V Blower/Sweeper  
DS128  
DS128-2

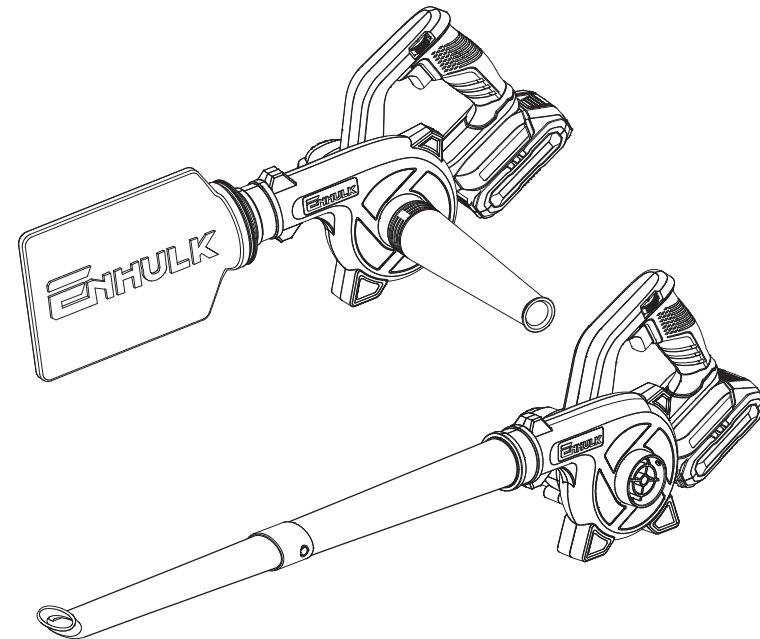

**SYVIO TECHNOLOGY.CO.LIMITED**  
ROOM A,8/F,wok Cheung Building,635-637  
Shanghai Street,Mong kok,Hong Kong  
Made in China

☎ 1 (877) 750-3787 (Mon.- Fri.9 to 5 PST)

✉ [service@enhulktools.com](mailto:service@enhulktools.com)

🏠 <http://www.enhulktools.com>

📘 @enhulkofficial

📷 @enhulkofficial

▶ @Enhulkofficial

Scan the QR code  
to watch the How-To  
videos



**Please Read Carefully Before Use  
Original Instruction Manual**

## Safety Instructions

### General Power Tool Safety Warnings

**⚠ WARNING** Read all safety warnings, instructions, illustrations and specifications provided with this power tool. Failure to follow all instructions listed below may result in electric shock, fire and/or serious injury.

**Save all warnings and instructions for future reference.** The term "power tool" in the warnings refers to your mainsoperated (corded) power tool or battery-operated (cordless) power tool.

- **Work area safety**
- **Keep work area clean and well lit.** Cluttered or dark areas invite accidents.
- **Do not operate power tools in explosive atmospheres, such as in the presence of flammable liquids, gases or dust.** Power tools create sparks which may ignite the dust or fumes.
- **Keep children and bystanders away while operating a power tool.** Distractions can cause you to lose control.

### Electrical Safety

**Power tool plugs must match the outlet. Never modify the plug in any way. Do not use any adapter plugs with earthed (grounded) power tools.**

Unmodified plugs and matching outlets will reduce risk of electric shock.

- **Avoid body contact with earthed or grounded surfaces, such as pipes, radiators, ranges and refrigerators.** There is an increased risk of electric shock if your body is earthed or grounded.
- **Do not expose power tools to rain or wet conditions.** Water entering a power tool will increase the risk of electric shock.
- **Do not abuse the cord. Never use the cord for carrying, pulling or unplugging the power tool. Keep cord away from heat, oil, sharp edges or moving parts.** Damaged or entangled cords increase the risk of electric shock..
- **When operating a power tool outdoors, use an extension cord suitable for outdoor use.** Use of a cord suitable for outdoor use reduces the risk of electric shock.
- **If operating a power tool in a damp location is unavoidable, use a residual current device (RCD) protected supply.** Use of an RCD reduces the risk of electric shock.

### Personal Safety

- **Stay alert, watch what you are doing and use common sense when operating a power tool. Do not use a power tool while you are tired or under the influence of drugs, alcohol or medication. A moment of inattention while operating power tools may result in serious personal injury.**

- **Use personal protective equipment. Always wear eye protection.** Protective equipment such as a dust mask, nonskid safety shoes, hard hat or hearing protection used for appropriate conditions will reduce personal injuries.
- **Prevent unintentional starting. Ensure the switch is in the off-position before connecting to power source and/or battery pack, picking up or carrying the tool.** Carrying power tools with your finger on the switch or energising power tools that have the switch on invites accidents.
- **Remove any adjusting key or wrench before turning the power tool on.** A wrench or a key left attached to a rotating part of the power tool may result in personal injury.
- **Do not overreach. Keep proper footing and balance at all times.** This enables better control of the power tool in unexpected situations.
- **Dress properly. Do not wear loose clothing or jewellery. Keep your hair and clothing away from moving parts.** Loose clothes, jewellery or long hair can be caught in moving parts.
- **If devices are provided for the connection of dust extraction and collection facilities, ensure these are connected and properly used.** Use of dust collection can reduce dust related hazards.
- **Do not let familiarity gained from frequent use of tools allow you to become complacent and ignore tool safety principles.** A careless action can cause severe injury within a fraction of a second.

### Power Tool Use And Care

- **Do not force the power tool. Use the correct power tool for your application.** The correct power tool will do the job better and safer at the rate for which it was designed.
- **Do not use the power tool if the switch does not turn it on and off.** Any power tool that cannot be controlled with the switch is dangerous and must be repaired.
- **Disconnect the plug from the power source and/or remove the battery pack, if detachable, from the power tool before making any adjustments, changing accessories, or storing power tools.** Such preventive safety measures reduce the risk of starting the power tool accidentally.
- **Store idle power tools out of the reach of children and do not allow persons unfamiliar with the power tool or these instructions to operate the power tool.** Power tools are dangerous in the hands of untrained users.
- **Maintain power tools and accessories. Check for misalignment or binding of moving parts, breakage of parts and any other condition that may affect the power tool's operation. If damaged, have the power tool repaired before use.** Many accidents are caused by poorly maintained power tools.

# Safety Instruction

- **Keep cutting tools sharp and clean.** Properly maintained cutting tools with sharp cutting edges are less likely to bind and are easier to control.
- **Use the power tool, accessories and tool bits etc. in accordance with these instructions, taking into account the working conditions and the work to be performed.** Use of the power tool for operations different from those intended could result in a hazardous situation.
- **Keep handles and grasping surfaces dry, clean and free from oil and grease.** Slippery handles and grasping surfaces do not allow for safe handling and control of the tool in unexpected situations.

## Battery Tool Use And Care

- **Recharge only with the charger specified by the manufacturer.** A charger that is suitable for one type of battery pack may create a risk of fire when used with another battery pack.
- **Use power tools only with specifically designated battery packs.** Use of any other battery packs may create a risk of injury and fire.
- **When battery pack is not in use, keep it away from other metal objects, like paper clips, coins, keys, nails, screws or other small metal objects, that can make a connection from one terminal to another.** Shorting the battery terminals together may cause burns or a fire.
- **Under abusive conditions, liquid may be ejected from the battery; avoid contact. If contact accidentally occurs, flush with water. If liquid contacts eyes, additionally seek medical help.** Liquid ejected from the battery may cause irritation or burns.
- **Do not use a battery pack or tool that is damaged or modified.** Damaged or modified batteries may exhibit unpredictable behaviour resulting in fire, explosion or risk of injury.
- **Do not expose a battery pack or tool to fire or excessive temperature.** Exposure to fire or temperature above 130°C may cause explosion.
- **Follow all charging instructions and do not charge the battery pack or tool outside the temperature range specified in the instructions.** Charging improperly or at temperatures outside the specified range may damage the battery and increase the risk of fire.

## Service

- **Have your power tool serviced by a qualified repair person using only identical replacement parts.** This will ensure that the safety of the power tool is maintained.

- **Never service damaged battery packs.** Service of battery packs should only be performed by the manufacturer or authorized service providers

## Safety Instructions For Blower

- **Do not blow any harmful substances, e.g. beech or oak wood dust, rock dust or asbestos.** These substances are classified as carcinogenic.
- **Do not blow any liquids.** The penetration of liquids increases the risk of an electric shock.
- **Pay attention that bystanders are not injured by foreign objects that are blown off by the product.**
- **Keep your fingers away from the openings of the power tool during operation. Only operate the blower with a nozzle attached.** The rotating fan can injure you.
- **Ensure that the workplace is well ventilated. Do not let children use the power tool unsupervised.** Children are at risk of injuring themselves this way.
- **Wear additional personal protective equipment such as protective glasses and a protective mask.** Wearing personal protection equipment appropriate to the conditions reduces your exposure to hazardous substances.



- **In case of damage and improper use of the battery, vapours may be emitted. The battery can set alight or explode.** Ensure the area is well ventilated and seek medical attention should you experience any adverse effects. The vapors may irritate the respiratory system.
- **Do not open the battery.** There is a risk of short circuiting.
- **The battery can be damaged by pointed objects such as nails or screwdrivers or by force applied externally.** An internal short circuit may occur, causing the battery to burn, smoke, explode or overheat.
- **Only use the battery with products from the manufacturer.** This is the only way in which you can protect the battery against dangerous overload.



Protect the battery against heat, e.g. against continuous intense sunlight, fire, dirt, water and moisture. There is a risk of explosion and short circuiting.



# Warning For Charger



## WARNING

Read all warnings and instructions. Failure to follow the warnings and instructions can cause electric shock, fire and/or serious injury. Save all warnings and instructions for future reference.

- a) The charger must not be used for non-rechargeable, ordinary batteries.
- b) Adequate ventilation is required.
- c) The information on current and voltage on the battery pack must comply with those of the charger.
- d) Do not expose the charger to water splashes and rain.
- e) Do not throw exhausted or damaged batteries into water or fire. Environmental guidelines must be followed.
- f) A defective or not chargeable battery must be treated as special waste / hazardous waste. Put it in a special collection point. Do not throw it in the normal household waste neither into water or fire.
- g) Place the charger far from any heat source.
- h) To reduce the risk of electric shock, pull the plug instead of the power cord out from the socket, if you want to disconnect the charger from the mains.
- i) Do not disassemble the charger. Bring it to an authorized repair service, if service or repair is required. Improper installation can result in electrical shock, death and fire.
- j) This appliance can be used by children aged from 8 years and above and persons with reduced physical, sensory or mental capabilities or lack of experience and knowledge if they have been given supervision or instruction concerning use of the appliance in a safe way and understand the hazards involved. Children shall not play with the appliance.
- k) Cleaning and user maintenance shall not be made by children.
- l) Do not leave the equipment unattended while it is operating, to avoid the risk of fire, burns and electric shocks.
- m) If the supply cord is damaged, it must be replaced by the manufacturer, its service agent or similarly qualified persons in order to avoid a hazard.

## Product Description And Specifications



**Read all the safety and general instructions.** Failure to observe the safety and general instructions may result in electric shock, fire and/or serious injury. Please observe the illustrations at the beginning of this operating manual.

### Intended Use

The power tool is intended for blowing away non-harmful substances (e.g. sawing debris, metal chips, stone dust, etc.) produced during sawing, drilling or grinding. Drill holes can also be blown out with the appropriate accessories. The power tool is not suitable for blowing hot, flammable or explosive materials.

# Symbols



Read the operator's manual



Always use eye/ear protection, Wear dust mask and safety helmet.



Do not expose to rain



Warning of hazard



Keep bystanders away



Do not dispose of waste batteries as unsorted municipal waste.



Do not burn



Li-Ion battery This product has been marked with a symbol relating to 'separate collection' for all battery packs and battery pack. It will then be recycled or dismantled in order to reduce the impact on the environment. Battery packs can be hazardous for the environment and for human health since they contain hazardous substances.

# Product Description And Specifications

Diagram of the power tool on the graphics page.

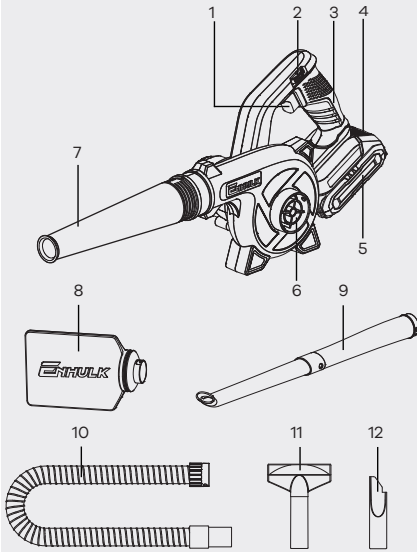

		DS128	DS128-2
1	On/off Trigger	●	●
2	Speed Adjust Switch	●	●
3	Handle	●	●
4	Battery Release Button	●	●
5	Battery	●	●
6	Air inlet	●	●
7	Dust tube	●	●
8	Dust bag	●	●
9	Blower Tube	●	●
10	Extension Hose	○	●
11	Wide Nozzle	○	●
12	Detail Nozzle	○	●

- : Attachment included
- : Attachment not included

## Technical Data

### 20V Blower/Sweeper

Article number	DS128/DS128-2
Voltage	20VDC
No-load speed	4000-18000RPM
Air speed	67-185MPH

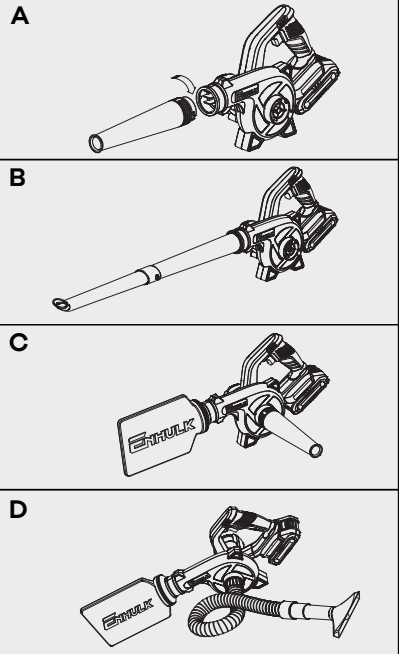

## Assembly

### Battery Charging

**Use only the chargers listed in the technical data.**

Only these chargers are matched to the lithium-ion battery of your power tool.

The battery is supplied partially charged. To ensure full battery capacity, fully charge the battery in the charger before using your tool for the first time.

The lithium-ion battery can be charged at any time without reducing its service life. Interrupting the charging process does not damage the battery.

**The lithium-ion battery is protected against deep discharge by Electronic Cell Protection (ECP). A protective circuit switches the power tool off when the battery is drained.**

**Do not continue to press the on/off switch after the tool has been automatically switched off.**

### Removing The Battery

The battery is equipped with two locking levels to prevent the battery from falling out if the battery release button is pressed unintentionally. As long as the battery is inserted in the power tool, it is held in position by means of a Spring.

# Maintenance and transportation

-To remove the battery (5), press the release button (4) and pull the battery upwards and out of the power tool. **Do not use force to do this. Follow the instructions on correct disposal. Fitting the blower accessories. Remove the battery before cleaning or performing maintenance work on the power tool, before making tool adjustments, changing accessories or storing the power tool.** This safety measure prevents the power tool from being started accidentally.

## Operation

After fully-charged the battery pack, carefully fit it into the blower with a "click". Make sure the battery pack is tight enough fitted with the blower.

## Starting Operation Switching On/Off

To switch on the blower/sweeper, press the on/off trigger(1), the blower/sweeper will keep working even you release the trigger.

To switch off the blower/sweeper, please press the on/off trigger(1) once again.

## Variable Speed

To operate the tool, select the speed setting you wish with the speed adjust switch(2), and press the on/off trigger. The speed setting can be adjusted either with the tool on or off.

Positions MIN through MAX inscribed on the speed adjust switch (2), the higher the number, the higher the tool speed.

## Working Advice

Never blow dirt in the direction of bystanders. Always hold the power tool approx. 3 cm above the ground when working. Do not blow hot, flammable or explosive material. The blower is intended for residential use only. Use the blower outdoors to move debris from hard surfaces. This blower is not designed to clear leaves from large grassy areas, or move wet, heavy debris.

## Cleaning And Maintenance

### WARNINGS

All maintenance should be carried out by a qualified person, do not try to repair any defect. When servicing, use only identical replacement parts. Use of any other part could create a hazard or cause product damage.

## Cleaning

Before cleaning or performing any maintenance, remove the battery from the blower/sweeper, use clean cloths to remove dirty, dust, oil, grease, etc. Always use only a soft, dry cloth to clean the plastic parts, never use detergent or alcohol. Always wear safety goggles when cleaning tools with compressed air.

## Storage

1. Switch the product off and remove the battery packs.
2. Clean the product and re-pack to original package.
3. Store the product and its accessories in a dark, dry, frost-free, well-ventilated place.
4. Always store the product in a place that is inaccessible to children. The ideal storage temperature is between 10°C and 30°C.
5. We recommend using the original package for storage or covering the product with a suitable cloth or enclosure to protect it against dust.

## Transportation

1. Switch the product off and remove the battery packs.
2. Re-pack to original package.
3. Protect the product from any heavy impact or strong vibrations which may occur during transportation in vehicles.
4. Secure the product to prevent it from slipping or falling over.

# Troubleshooting

Fault	Cause	Remedy
The Blower/Sweeper doesn't run	Low battery power	Charge the pack
	Bad connect between electrical connection	Take out the pack or cigarette charger and re-fit it
Blower/Sweeper stop suddenly	Too hot for the machine or battery pack	Waiting for a time and let it cool
Can not blow/Sweep	Air inlet blockage	Check with air inlet

# Guarantee

## Guarantee

Dear Customer,  
This equipment is provided with a 2-year guarantee from the date of purchase. In case of defects, you have statutory rights against the seller of the product. These statutory rights are not restricted by our guarantee presented below. Terms of Guarantee the term of the guarantee begins on the date of purchase, please retain the original receipt and it's required as proof of purchase. If a material or manufacturing defect occurs within 2-year of the date of the purchasing, we will repair or replace the product for you free of charge. This guarantee requires the defective equipment and proof of purchase to be presented within the 2-year period with a brief written description of what constitutes the defect and when it occurred. If the defect is covered by our guarantee, you will receive either the repaired product or a new product. No new guarantee period begins on repair or replacement of the product.

## Guarantee Period And Statutory Claims For Defects

The guarantee period is not extended by the guarantee service. This also applies for replaced or repaired parts. Any damages and defects already present at the time of purchase must be reported immediately after unpacking.